

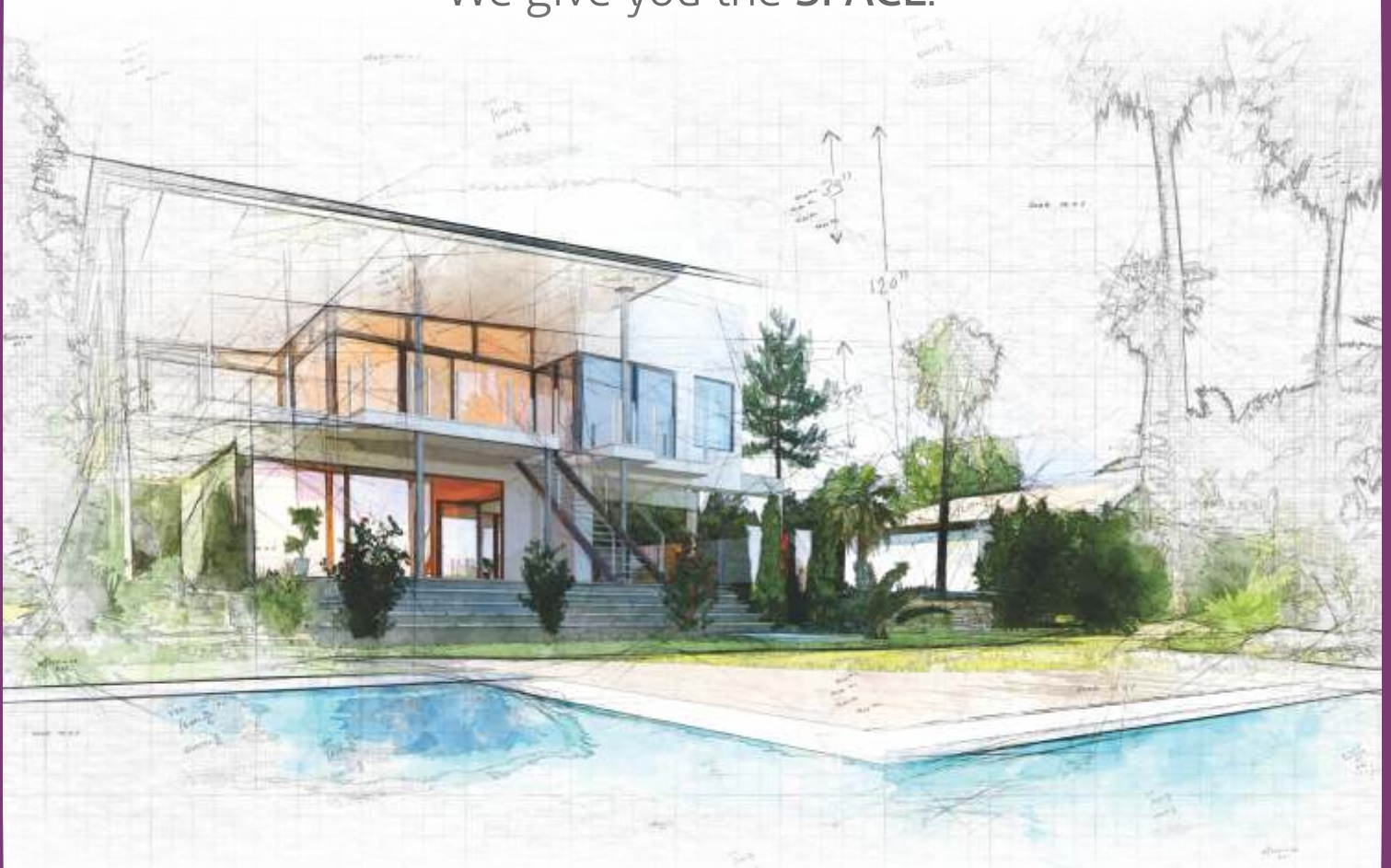

We give you the **SPACE.**



Design and build **#YourDreamHome** to your satisfaction.

mantra

essence

NA Bungalow Plots, Undri



\*Image for representational purpose only

## Because you want to find the Best way to *#DesignTheirTomorrow.*

Your children fill your present with incredible joy and you want to fill their future with utmost happiness. You'd like to make sure they get every little comfort and luxury effortlessly. Now and always.

This is where you get a chance to design their tomorrow in the most planned manner. Now build your home to your satisfaction. Mantra Essence NA Bungalow Plots in Undri allow you to design and build your dream home the way you want it.

Build your home the bespoke way. Plan every little detail in nook and corner to make sure your tomorrow gets every little comfort and luxury the way it should.

## Convenience *#AsYouLikelt.*

Living at Mantra Essence, you are literally minutes away from everything.

Mantra Essence is at the centre of the Undri growth story. Located minutes away from all the essential conveniences of life like shopping centres, schools, hospitals and recreational centres, it scores high on connectivity with highways and arterial road.



Hospitals



Schools



IT Parks



Shopping Malls



Transport



Recreational Centres

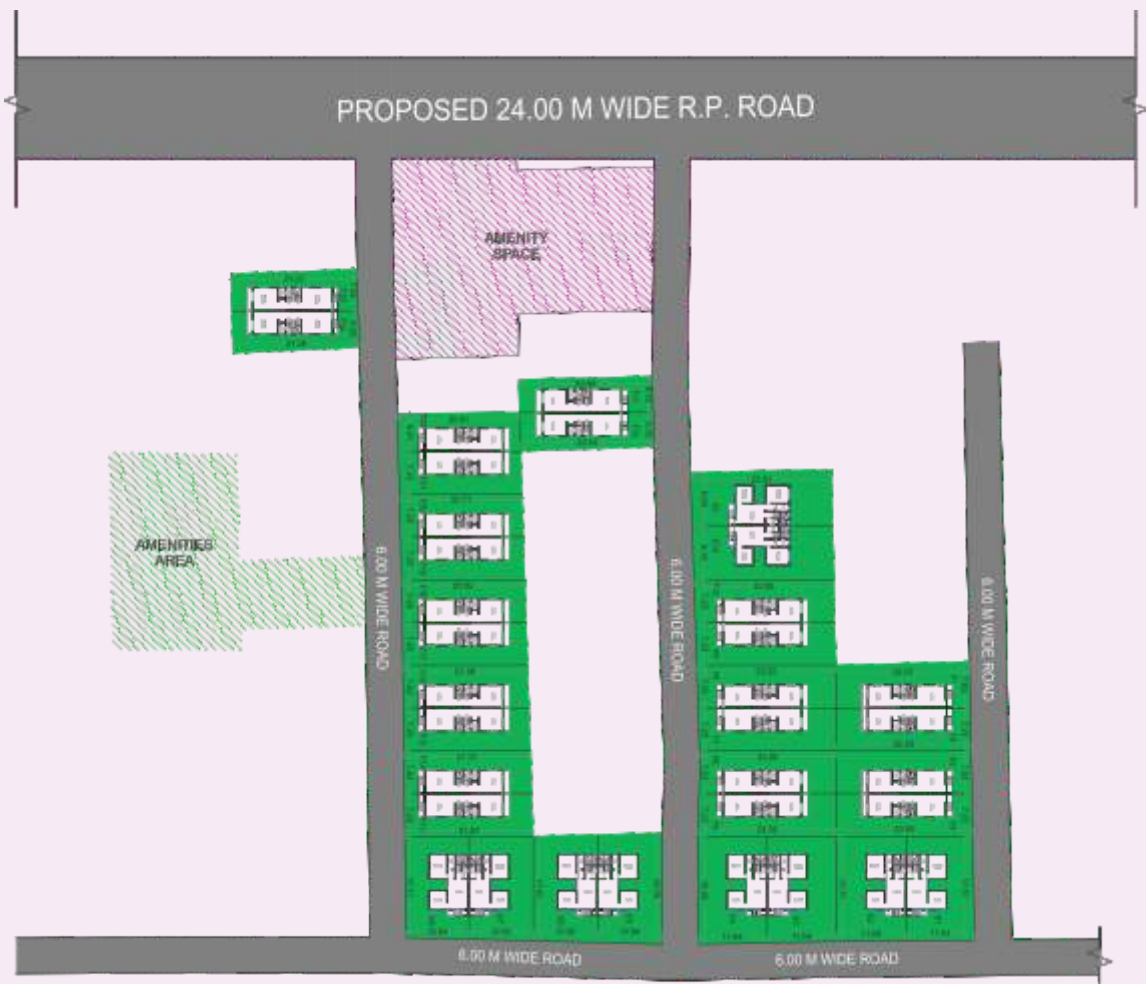

## Because you want to do the Best for your family.

Your decision to buy a bungalow plot at Mantra Essence will do a lot of things for you - make you the best Dad in the world, the most caring Spouse, and the most foresighted investor. How about an investment that will not only grow in leaps and bounds without risk, but in doing so, unmatched joy of living?

Mantra Properties offers bungalow plots that will suit your needs. Ranging from 1425.58 sq. ft. to 2346.66 sq. ft., you can choose your bundle of joy and also have the satisfaction of having your own home the way you like. Mantra Properties brings you this opportunity to do the best for your family!



1. Mother's Corner
2. Seating Area
3. Children's Play Area
4. Yoga Deck
5. Jogging Track
6. Barbecue Station
7. Central Plaza
8. Entrance Plaza
9. Outdoor Gym
10. Senior Citizen Court with Gazebo
11. Party Lawn
12. Stage



\*Image for representational purpose only

## Work hard and Unwind harder *#ToYourSatisfaction.*

Whatever you and your family want to do, there's something for everybody here. Mantra Essence NA Bungalow Plots has a plethora of amenities for just about everyone in your family. After a long day, unwind near the water body or sweat it out in the gym while your parents can have meet-ups in the sitout area and your child can be carefree in the play area.

Enjoy the unmatched amenities of Mantra Essence apartments situated next door.



Party Lawn



Barbecue Area



Open Gym



Senior Citizen Sitout



Landscaped Garden



Children's Play Area

## Plotting Infrastructure



Compound Wall



Internal Tar Road



Drainage Connection Provision



Provision for Electrical Connection



Provision for Water Line Connection

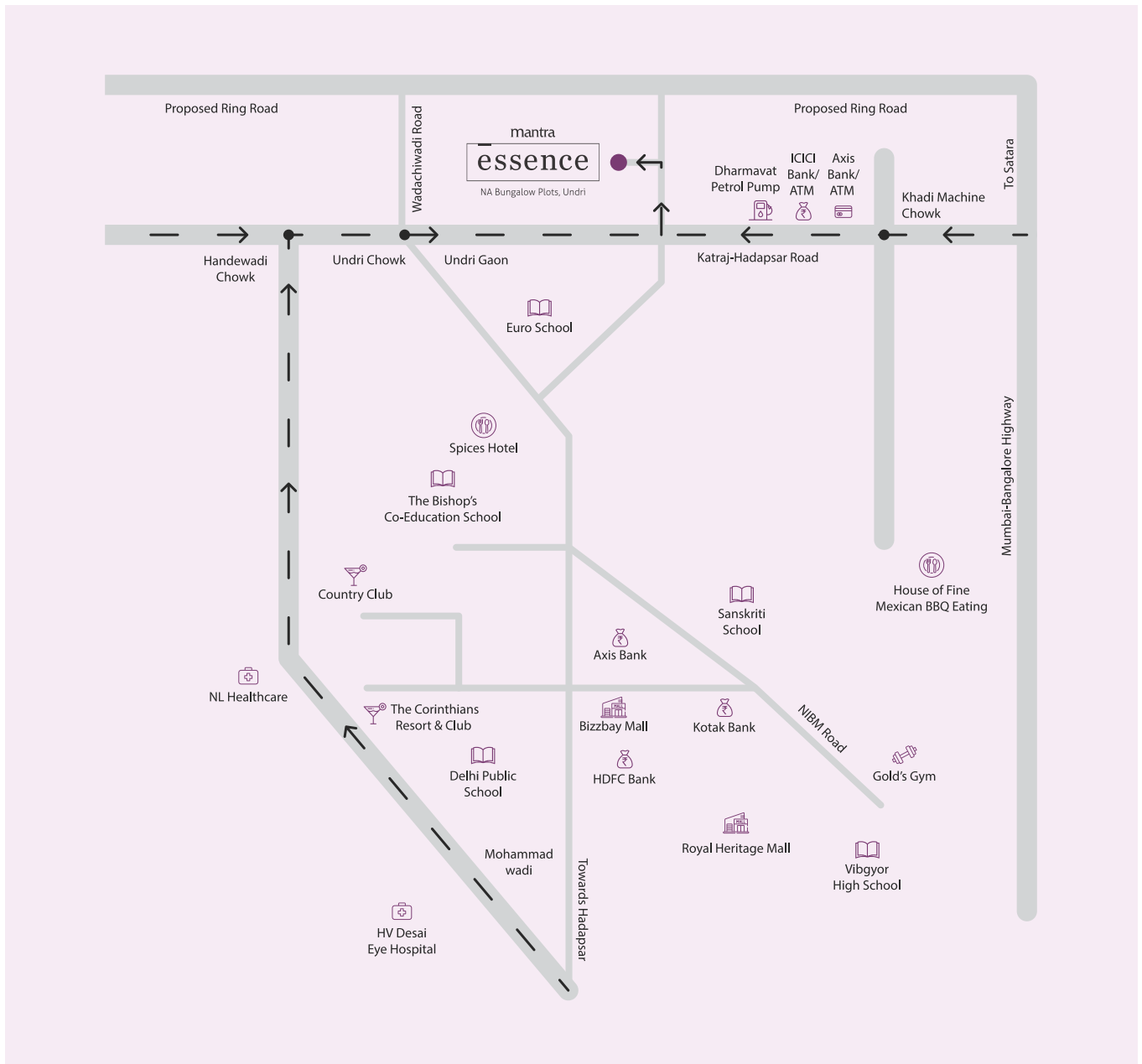

## Every convenience minutes away.

### Schools

- The Bishop's School 30 mins.
- Euro Kids Pre-school 9 mins.
- RIMS International School 15 mins.
- Sanskriti School 9 mins.
- Delhi Public School 10 mins.

### Hospitals

- Chintamani Hospital 6 mins.
- Ruby Hall Clinic 20 mins.
- Satyanand Hospital 15 mins.

### Banks & ATMs

- State Bank of India 25 mins.
- ICICI Bank 15 mins.
- HDFC Bank 30 mins.
- Axis Bank 35 mins.

### Shopping & Entertainment

- Royal Heritage Mall 10 mins.
- More Supermarket 20 mins.
- D-Mart 15 mins.
- Inox 10 mins.
- E-Square Konark 15 mins.

### Hotels & Restaurants

- The Corinthians Club 8 mins.
- Royal Park 5 mins.
- The Spices 5 mins.
- Krabi Town 12 mins.



## The Mantra of *#Making Lives Better.*

A real estate company born in 2007, Mantra Properties is a brand that has expanded rapidly across Pune's horizon. Currently, we are developing over 24 projects, spanning across 50 lakh sq. ft. in different neighbourhoods of the city. Our core mantra has always been to give you a better life by designing the homes of your dreams.

Since the time we started, we are known for the way we craft our homes. We listen to your needs, think through every little detail and provide you the best value. We have earned the trust of our customers through our quality in work, transparency in business and timely delivery.



**Site Address:** Pisoli Road, Shree Siddhivinayak Meera, Undri, Pune - 411 060.

**Head Office:** The Metropole, 3<sup>rd</sup> Floor, Next to INOX, Bund Garden Road, Camp, Pune, Maharashtra - 411 - 001.

[www.mantraproperties.in](http://www.mantraproperties.in)

MahaRERA Registration No.: P52100001796

---

#### OTHER PROJECTS:

Mantra 99 Riverfront, Baner | Mantra 7 Hills, Kirkatwadi | Mantra Magic, Chimbali | Mantra Insignia, Mundhwa | Mantra Essence, Undri | Mantra Residency, Nighoje  
Mantra City 360, Talegaon | Mantra Parkview, Dhayari | Mantra 24 West, Gahunje | Mantra Moments, Borhadewadi | Mantra Divine, Wadebolai, Wagholi Annexe  
29 Gold Coast, Tingre Nagar | Mantra Grand Stand Trinity, Kothrud

---

Disclaimer: All the designs, images, specifications, facilities and other details herein are purely indicative in nature and the intended recipient should note that these are to be treated as purely provisional and informative and as such only. We reserve the right to modify / change / amend / alter any of the aforesaid in the best interest of the development and as per RERA regulations. The contents herein should not be construed as an offer / invitation to offer / contract. This printed material inter alia images, contents therein are for representative purpose only. Any party desirous / interested in the project needs to enter in to an Agreement for Sale.